

ASIAN
habitat64

Developed by



Sikkim Commerce House, 4/1 Middleton Street, Kolkata 700 071

Phone: +91 33 22877334/22879732/22879320 | Fax: +91 33 22803101 | Email: habitat64@asiangroup.in, mail@asiangroup.in



"Maheswari & Associates", 37A Baker Road, Alipore, 2nd Floor, Kolkata 700 027

Phone: +91 33 65228584/24490323 | Fax: +91 33 24490322 | Email: info@architectm.com

Marketed by



20/1 Ashutosh Chowdhury Avenue, Kolkata 700 019

Customer Care: 98311 05222 | Phone: +91 33 4010 4010 | Fax: +91 33 4010 4020 | Email: resi@amitproperties.com

Disclaimer - This is not a legal document, the plans and photographs are conceptual. The actual product may vary according to the sole discretion of the developer. No claims shall be entertained based on this material.



ASIAN
habitat64
ELEVATE TO NEW HEIGHTS



On Andul Road
near the world famous
Botanical Gardens
will come up
Asian Habitat64
comprising of
Andul's tallest building
a majestic tower,
11 stories
It will be the home and habitat
of 64
modern progressive families.



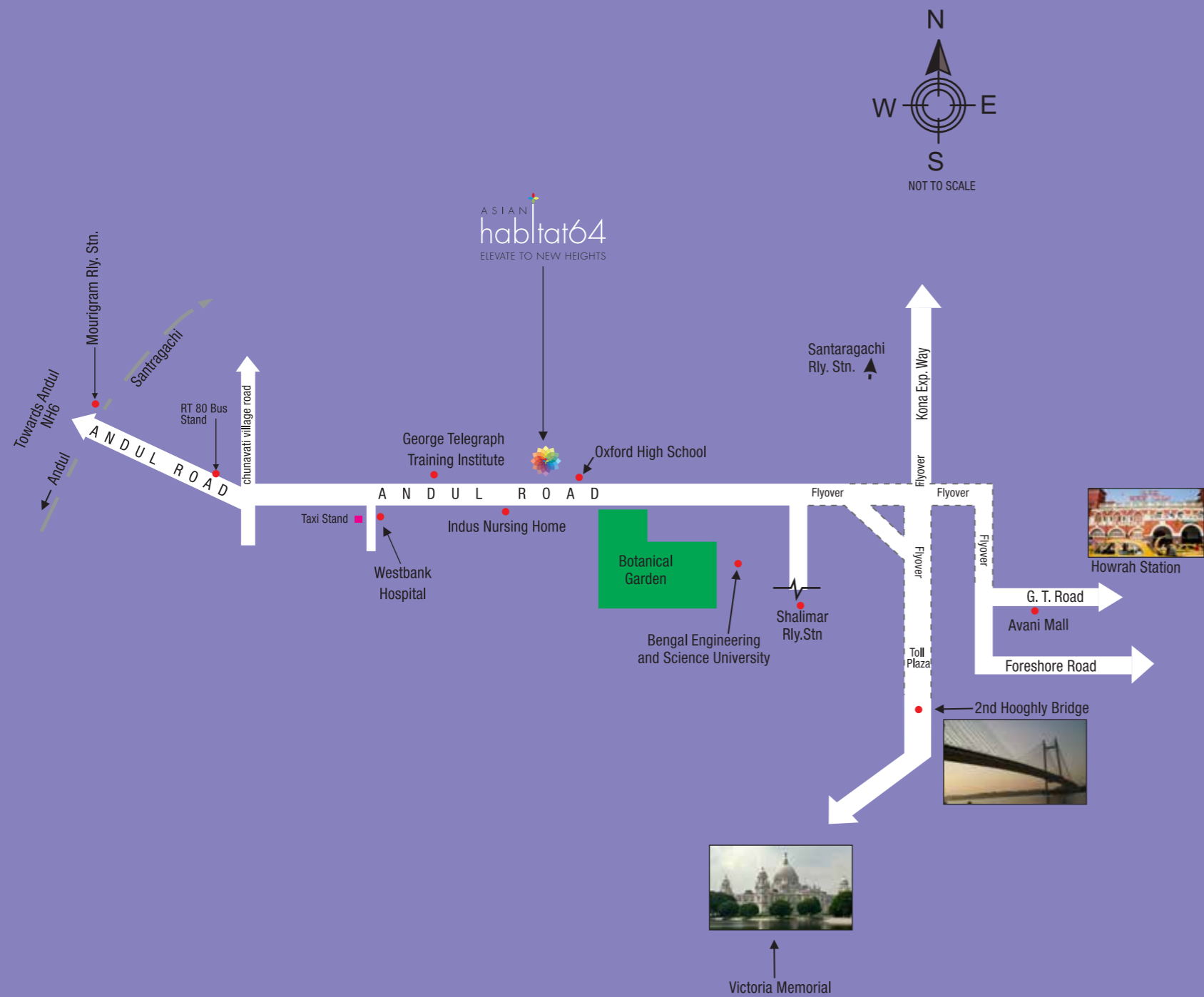

Joy on top of Convenience

Situated in close proximity to the heart of Kolkata and its major railway stations, it's a dream location in the city of joy and also a commuter's delight. Easily accessible by road, rail and across the river, it is only minutes away from different parts of Kolkata and Howrah. Asian Habitat64 basks in the glory of Bengal's golden age, with Andul Rajbari and Sapta Shiva Mandir in its neighbourhood. In addition, the Avani Riverside Mall and other shopping and leisure destinations nearby will provide the most efficient and enjoyable utilisation of leisure hours. Top of the class medical and educational institutes add to Asian Habitat64's comfort and convenience.

Asian Habitat64 is nestled very close to The Botanical Gardens, tucked away from the cacophony of the noisy city streets, but still within:-

4 km / 10 mins from Vidyasagar Toll Gate

4.5 km / 10 mins from Avani Riverside Mall

2.5 km / 5 mins from Botanical Garden

3.5 km / 7 mins from Bengal Engineering & Science University

10 km / 25 mins from Esplanade

6.0 km / 20 mins from Howrah Station

4.0 km / 10 mins from Shalimar Station

Elevated State of Living

The 64 blessed families at Asian Habitat64 will form a perfect symphony, all equally important parts of a larger evolving sphere, living in the lap of bountiful nature. Under protection from the best of security standards 24/7.

Be able to feast your eyes on the majestic view of The Vidyasagar Setu. Let the sunrise and the sunset on the beautiful river add that perfect backdrop to your memories of life. Fascinate yourself and your children with the richest nature archive available in Kolkata at The Botanical Garden. The landscaped roof top garden will be the perfect hangout at the convenience of your home, which also hosts birds and peace.

The community hall can host any social or cultural event and celebrate every big festival round the year. Pump up your adrenaline at the multi-gymnasium.

Asian Habitat64 includes shops to serve all daily needs, saving time and energy. So that the residents at Asian Habitat64 are charged up always.

24 x 7 Security with Intercom
Roof Top Garden & Children's Play Area
Multi Purpose Hall
Gymnasium
Shops





Highest Assurance of Quality

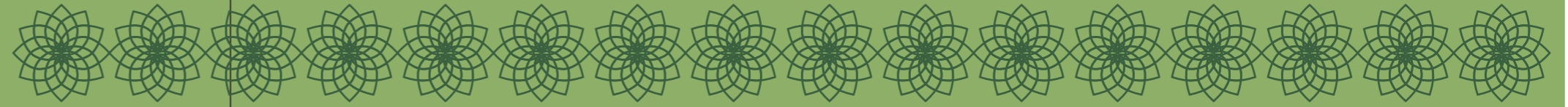

Structure

Earthquake resistant RCC framed structure

Flooring

Bedrooms, Living & Dining – Vitrified tiles
 Passage & Lobby – Anti skid vitrified / Kota
 Staircase & Landing – Kota / Kadappa
 Parking & Driveway – Pavers / neat cement plaster
 Roof – Roof garden after proper waterproofing and children play area

Wall Finish

Interior-Plaster of Paris
 Exterior-High quality weather proof Cement/texture paint

Kitchen

Anti Skid Ceramic tiled floor
 Granite Counter
 Stainless steel sink
 Dado of ceramic tiles
 Electrical point for refrigerator, water filter, exhaust fan, oven

Toilet

Anti skid ceramic tiled floor
 Dado of Ceramic tiles on the wall
 White sanitary ware of a reputed make
 CP fittings point for geyser
 Plumbing provision for hot/cold water lines

Doors & Windows

Tough timber frames and flush shutter
 Entrance-laminated flush doors
 Entrance door fittings-night latch with eyepiece and handle
 Internal bedrooms-flush door enamel painted with lock
 Toilet-doors enamel painted
 Windows aluminium casement with fully glazed shutters

Electricals

Modular switches of reputed make
 AC point in master bedroom and Living / Dining
 Necessary electrical points with switches in all bedrooms, Living / Dining, Kitchen and Toilets.
 Cable TV conduiting in living/dining and master bedrooms
 Telephone line in living / dining
 Concealed copper wiring with central MCB of reputed make
 Door bell point at entrance door
 Automatic Change over for Generator Supply –
 500 KV for 2 BHK and 750 KV for 3 BHK

Elevators

High speed elevators Automatic of Otis / Kone / Schindler / Jhonson make

Fire Protection System

As per norms of W.B.F.S



Ground Floor Plan



First Floor Plan

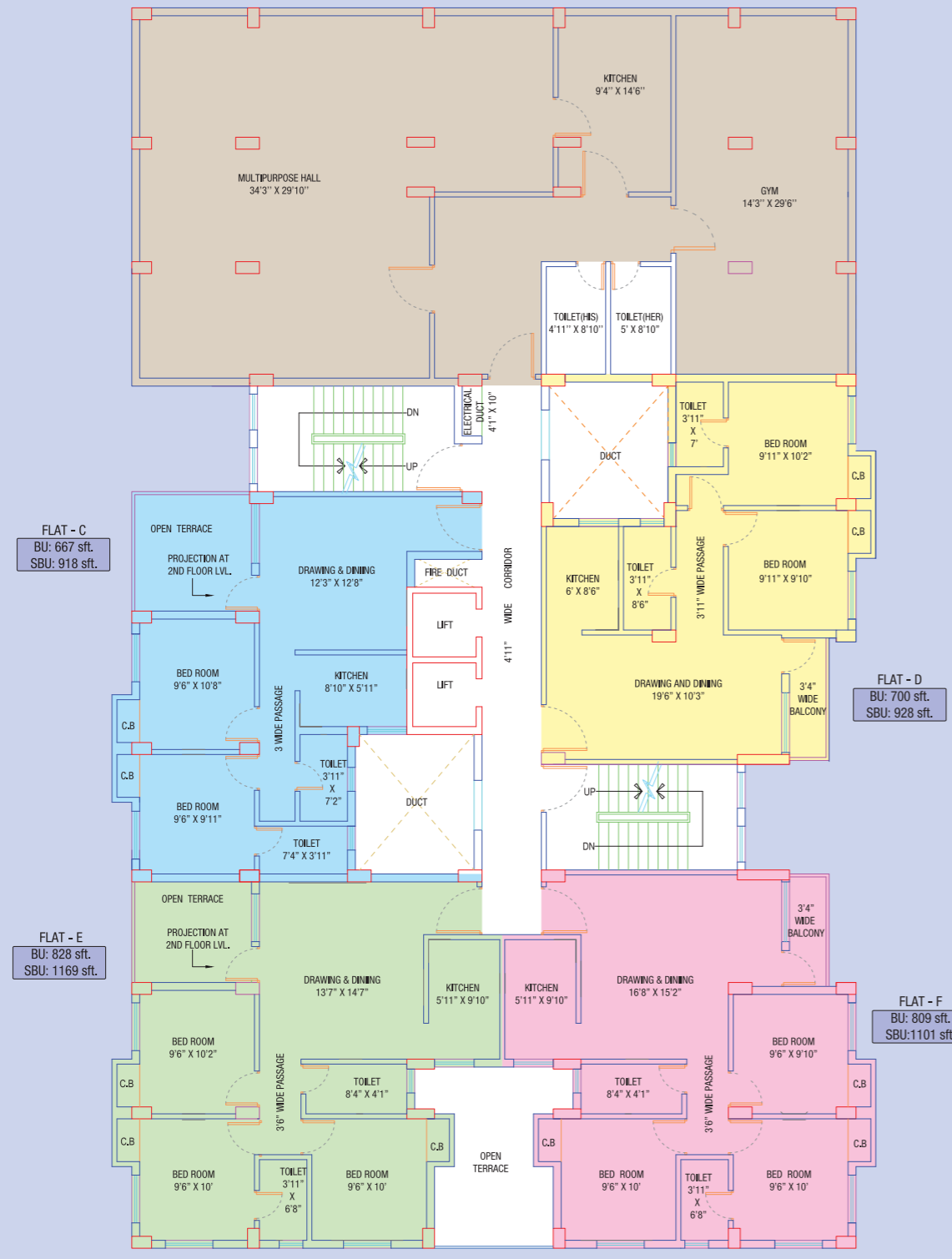

Typical Floor Plan



Height of Excellence

"Asian Habitat64" is being developed by **Asian Group**.

This highly respected real estate group has made several coveted projects like Sikkim Commerce House, Meghalaya House, a multi-specialty hospital at New Alipore, Commercial building off Hazra Road, etc. The Asian group continues their leadership with several upcoming projects like "The Unimark Asian" commercial project on Shakespeare Sarani, a commercial project on AJC Bose Road, and in Siliguri- "The Universe", "Indigo" and "Skyview" residential projects. The group has always maintained its legacy of excellence for over two decades under the astute leadership of the founder and chairman **Mr H R Garg**.

"Asian Habitat64" is designed by the acclaimed architect: **Maheswari Associates**. The famous architectural and interior design firm under the eminent vision of **Mr Kamal Periwai**, has developed and designed more than ten million square feet in the last 15 years. Tata Housing, Digital Cube and Spacio in Kolkata, Protech Park in Guwahati, Devji Sadan and JVPD Kalyani in Mumbai are just a few examples of their previous works. That is why residents at Habitat64 will not merely live in a concrete structure of brick and mortar but at the height of excellence, care and delight.



Hires photograph required

SIKKIM COMMERCE HOUSE, MIDDLETON STREET



MEGHALAYA HOUSE, RUSSEL STREET



UPCOMING OFFICE SPACE, HAZRA



UNIMARK ASIAN, THEATRE ROAD

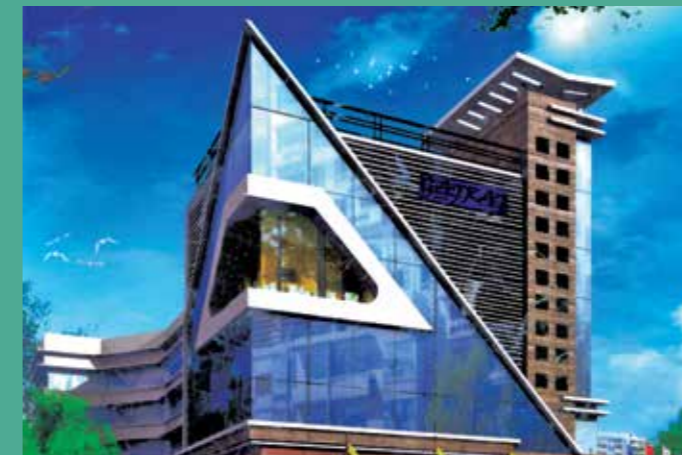

UPCOMING OFFICE SPACE, AJC BOSE ROAD



THE UNIVERSE, SILIGURI